

SPECIFICATIONS

Forged brass body. Cadmium plated vinyl insulated handle.
Chrome-plated brass ball with nylon seat.

REGULARLY FURNISHED

Ball Type Shut-off Valves - For use with sprinkler systems, dry sprinkler systems, standpipe systems and manual deluge control valves.

MODEL SELECTION

VALVES

- 4405
- 4407
- 4410
- 4412
- 4415
- 4420
- 4425
- 4430



PRODUCT OPTIONS

“No Available Options”

MODEL DIMENSIONS

Model No.	Size	A	B	C	D	Pressure Rating P.S.I.
4405	1/2*	2-3/16	1-3/8	0.472	3-1/16	600
4407	3/4*	2-1/2	1-3/4	0.672	3-13/16	600
4410	1*	3	1-7/8	0.891	3-13/16	500
4412	1-1/4*	3-7/16	2-1/16	1.109	3-13/16	500
4415	1-1/2*	3-3/4	2-3/8	1.378	4-13/16	500
4420	2*	4-3/8	2-11/16	1.772	4-13/16	500
4425	2-1/2	5-3/4	3-1/4	2.25	6	400
4430	3	6-1/4	3-1/2	2.625	6	400

ALL DIMENSIONS IN INCHES

NOTE: * = U/L Listed & FM Rating

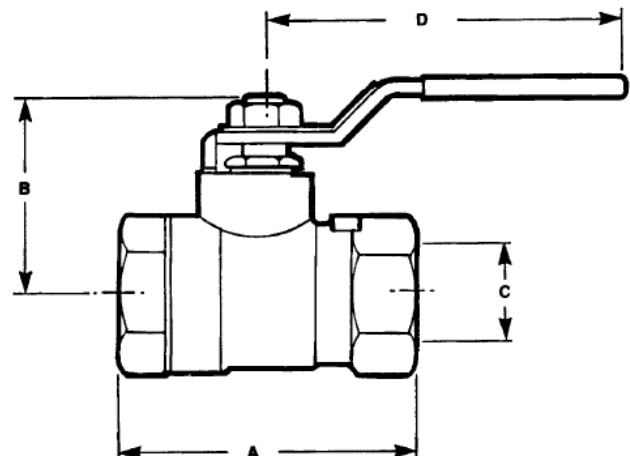

Call Potter Roemer - Fire Pro for current listings and approvals. Dimensions are subject to manufacturer's tolerance and may change without notice. Potter Roemer-Fire Pro assumes no responsibility for use of void or superseded data. © Copyright Potter Roemer-Fire Pro, Member of Morris Group International™ Please visit potterroemer.com for most current specifications.

4400 SERIES

Date: 03/27/14

MEMBERSHIP



FIRE EQUIPMENT
MANUFACTURERS'
ASSOCIATION

ONFSA
NATIONAL IRRIE SPRINKLER ASSOCIATION, INC.



CASPE
American Society of
Plumbing Engineers



POTTER ROEMER/FIRE PRO

Headquarters:
P.O. Box 3527
City of Industry, CA
91744 U.S.A.
Los Angeles Area
800-366-3473
626-855-4890

Also in:
New York (800) 526-4592
Chicago (800) 547-3473
Atlanta (800) 762-0542
Miami (866) 961-3473
Dallas (866) 644-3473

www.potterroemer.com